

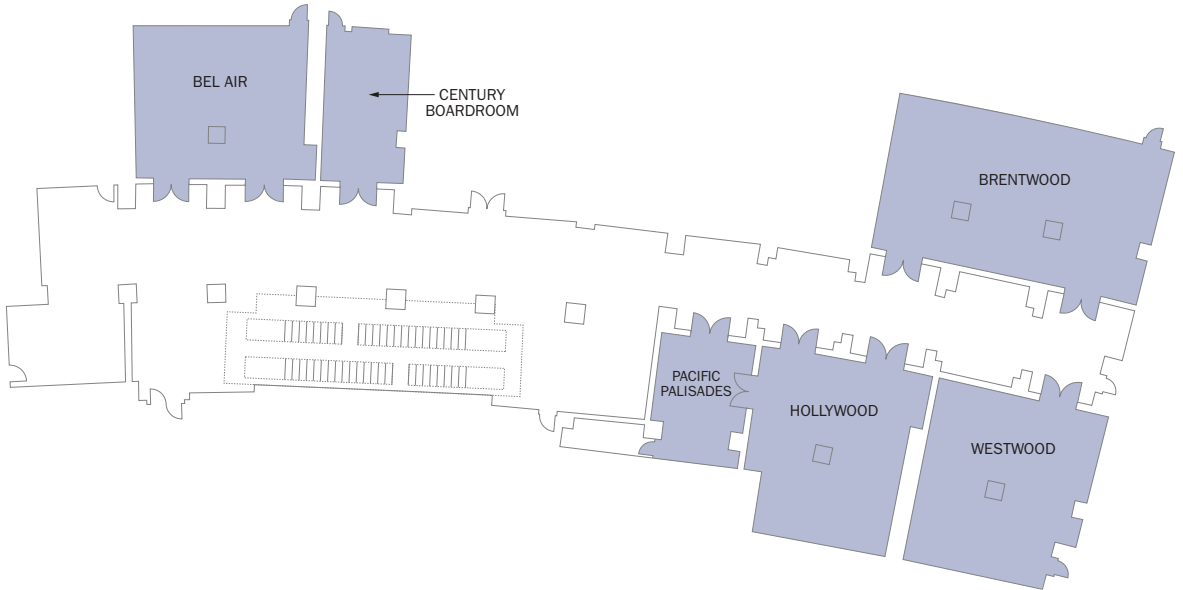

FLOOR PLAN

CENTURY LEVEL - P1



CAPACITY CHART

	OVERALL DIMENSIONS		SQUARE		HEIGHT		CAPACITIES								MAX. OCCUPANCY
	FEET	METERS	FEET	METERS	FEET	METERS	66" ROUNDS	RECEPTION	THEATER	CLASSROOM	BOARDROOM	U-SHAPE	H/S		
CENTURY LEVEL - P1															
BEL AIR	28' x 25'	8.5 x 7.6	700	65	11'	3.4	48	48	48	42	24	27	30	48	
BRENTWOOD	45' x 26'	13.7 x 7.9	1,170	108	11'	3.4	79	79	79	51	42	20	42	79	
WESTWOOD	28' x 30'	8.5 x 9.1	840	78	11'	3.4	55	55	55	42	24	24	30	55	
HOLLYWOOD	25' x 30'	7.6 x 9.1	750	69	11'	3.4	52	52	52	30	24	21	24	52	
PACIFIC PALISADES	15' x 20'	4.5 x 6.1	300	27	11'	3.4	21	21	21	-	10	-	-	21	
CENTURY BOARDROOM	14' x 25'	4.2 x 7.6	350	32	11'	3.4	-	-	-	-	20	-	-	24	

Duane Mah
 Director of Conference Services and Catering

Fairmont Century Plaza
 Pre-Opening Offices
 10250 Constellation Boulevard
 16th Floor, Suite 1640
 Los Angeles, CA 90067
 T 310.246.4774
 duane.mah@fairmont.com



FLOOR PLAN

CALIFORNIA LEVEL - P2

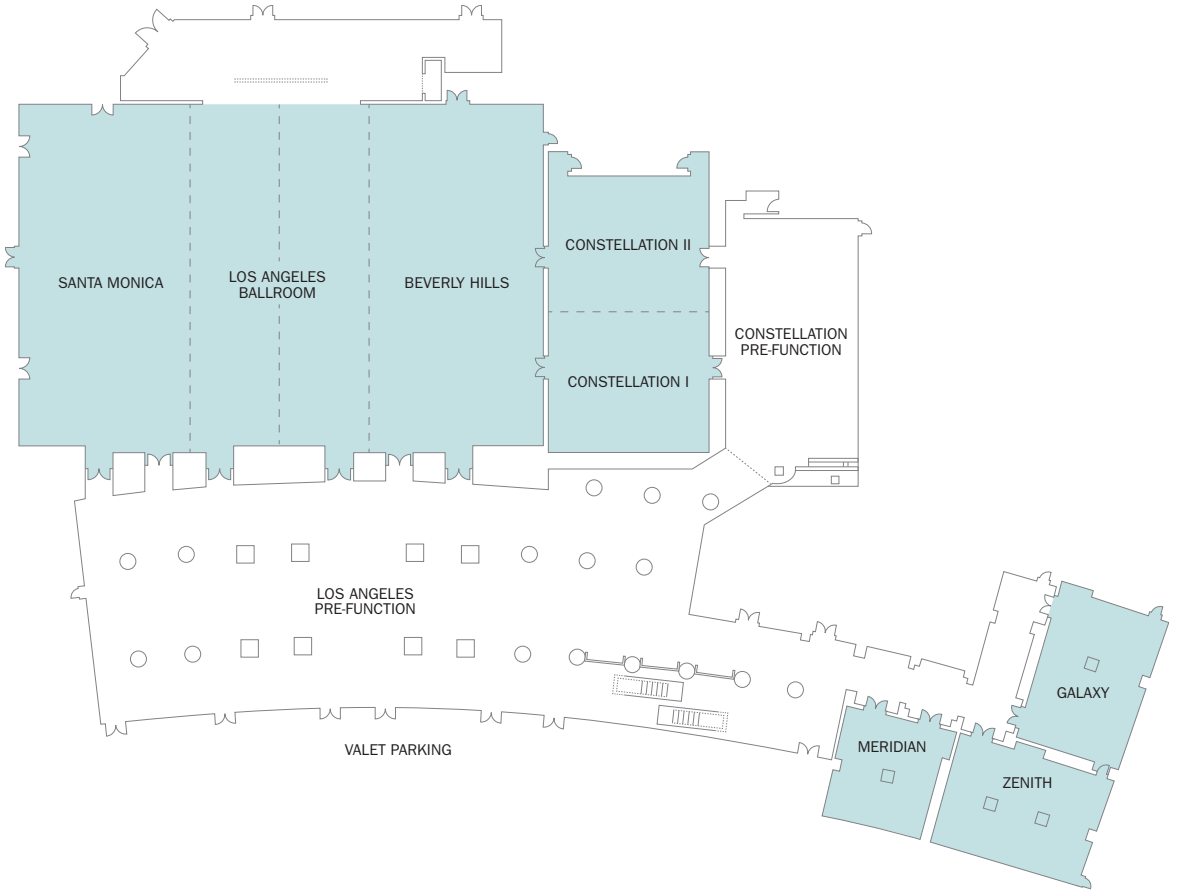

CAPACITY CHART

	OVERALL DIMENSIONS		SQUARE		HEIGHT		CAPACITIES							
	FEET	METERS	FEET	METERS	FEET	METERS	66" ROUNDS	RECEPTION	THEATER	CLASS-ROOM	BOARD-ROOM	U-SHAPE	H/S	MAX. OCCUPANCY
CALIFORNIA LEVEL - P2														
LOS ANGELES BALLROOM	139' x 91'	42.3 x 27.7	13,078	1,214	20'	6	1,512	1,868	1,475	800	-	-	-	1,868
LOS ANGELES BALLROOM HALF	69' x 91'	21.0 x 27.7	6,539	607	20'	6	756	934	700	400	-	-	-	934
SANTA MONICA	46' x 91'	14.0 x 27.7	4,359	404	20'	6	432	622	400	250	-	-	-	622
LOS ANGELES	46' x 91'	14.0 x 27.7	4,359	404	20'	6	432	622	400	250	-	-	-	
BEVERLY HILLS	46' x 91'	14.0 x 27.7	4,359	404	20'	6	432	622	400	250	-	-	-	
SANTA MONICA AND LOS ANGELES	92' x 91'	28.0 x 27.7	8,718	808	20'	6	864	1,244	800	500	-	-	-	
LOS ANGELES AND BEVERLY HILLS	92' x 91'	28.0 x 27.7	8,718	808	20'	6	864	1,244	800	500	-	-	-	
LOS ANGELES PRE-FUNCTION	160' x 61'	48.7 x 18.6	9,760	906	9'-18'-9"	2.7-5.7	-	1,828	-	-	-	-	-	1,828
CONSTELLATION	42' x 73'	12.8 x 22.2	3,066	284	20'	6	336	466	300	180	70	75	84	466
CONSTELLATION 1	42' x 36.5'	12.8 x 11.1	1,533	142	20'	6	144	233	130	80	30	32	36	233
CONSTELLATION 2	42' x 36.5'	12.8 x 11.1	1,533	142	20'	6	144	233	130	80	30	32	36	233
CONSTELLATION PRE-FUNCTION	35' x 64'	10.6 x 19.5	2,240	208	8'3"	2.5	-	-	-	-	-	-	-	466
GALAXY	29' x 42'	8.8 x 12.8	1,218	113	9'	2.8	85	85	85	45	24	21	30	85
MERIDIAN	27' x 30'	8.2 x 9.1	810	75	9'	2.8	58	58	58	58	36	24	30	58
ZENITH	42' x 30'	12.8 x 9.1	1,260	117	9'	2.8	86	86	86	80	36	27	30	86